

# ElectroShade® DoubleShade® Brackets

ThermoVeil® or EuroVeil® SunScreens with Blackout ShadeCloth on a Single Bracket with SnapLoc® Fascia (optional).

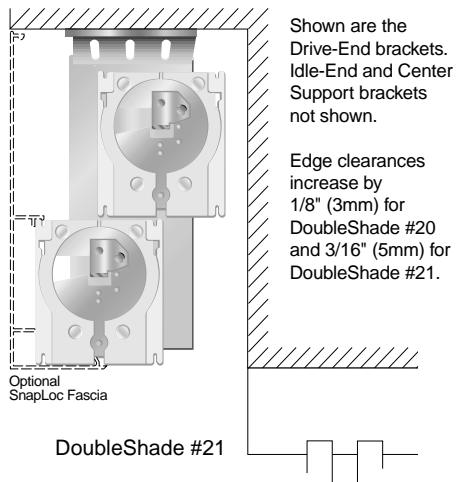
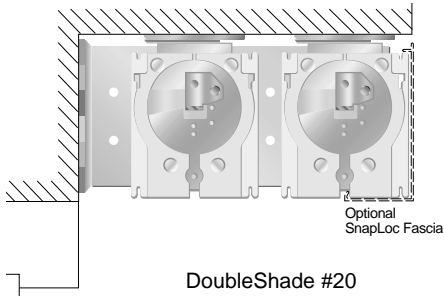

DoubleShades® have all the same features of the standard Mecho®/5 bracket, plus allow both sun screen and room darkening on a single bracket.

## Compact Size

DoubleShade's compact size allows two shades to fit in a smaller room projection than two individually installed shades on the same window.

## Ease of Installation

DoubleShades provide faster, easier, more economical installation of two shades per window. The mounting brackets require less measuring and are pre-spaced to insure proper alignment of both shades in relation to each other.

## Electro®/3 DoubleShade® Bracket #20, with and without fascia.

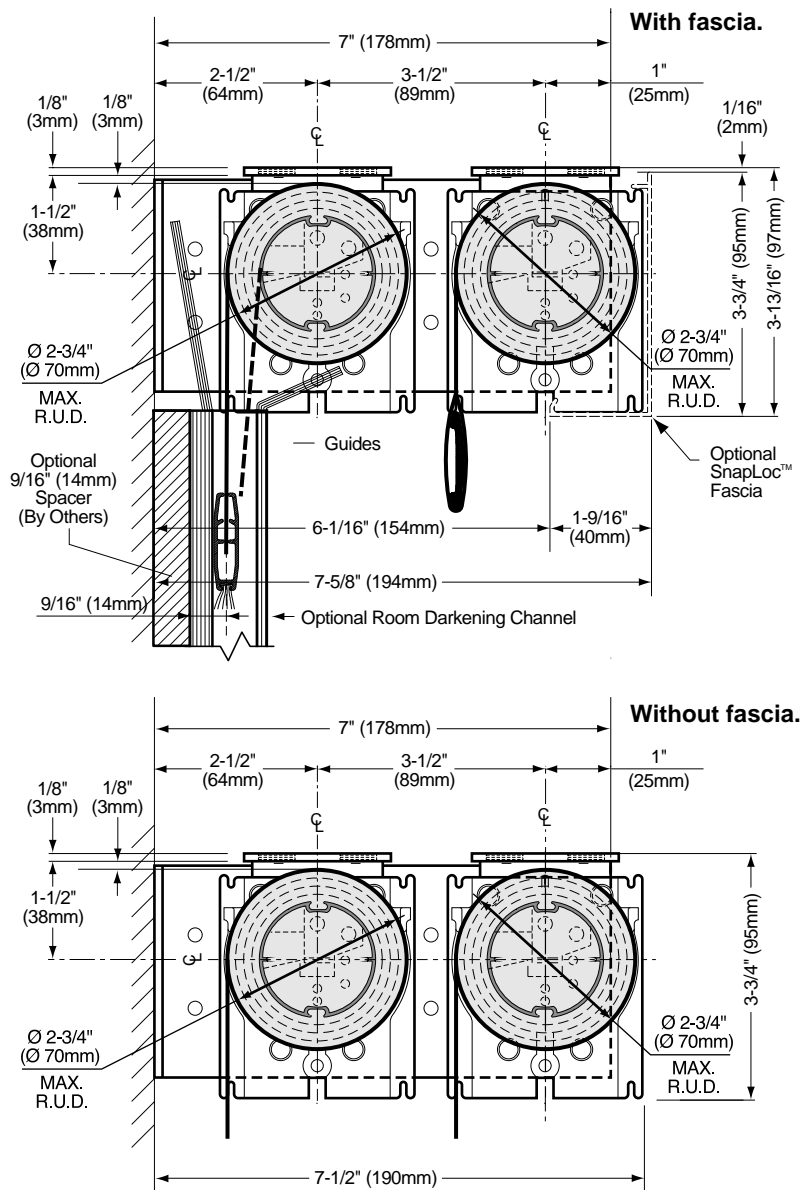

- DoubleShade Brackets require that both the solar and blackout operating brackets on a DoubleShade assembly have the same right-hand drive or left-hand drive orientation.
- For assistance on proper bracket and tube selection please contact your local representative or MechoShade technical support.

MechoShade Systems, Inc.  
42-03 35th Street, Long Island City, NY 11101  
Telephone: 718-729-2020  
Fax: 718-729-2941 / 800-899-8081

E-mail: [info@mechoshade.com](mailto:info@mechoshade.com)  
Internet Web Site: <http://www.mechoshade.com>

**3.15**  
MS2200-6/104



# ElectroShade® DoubleShade® Brackets

## Electro®/3 DoubleShade® Bracket #21 with and without fascia.

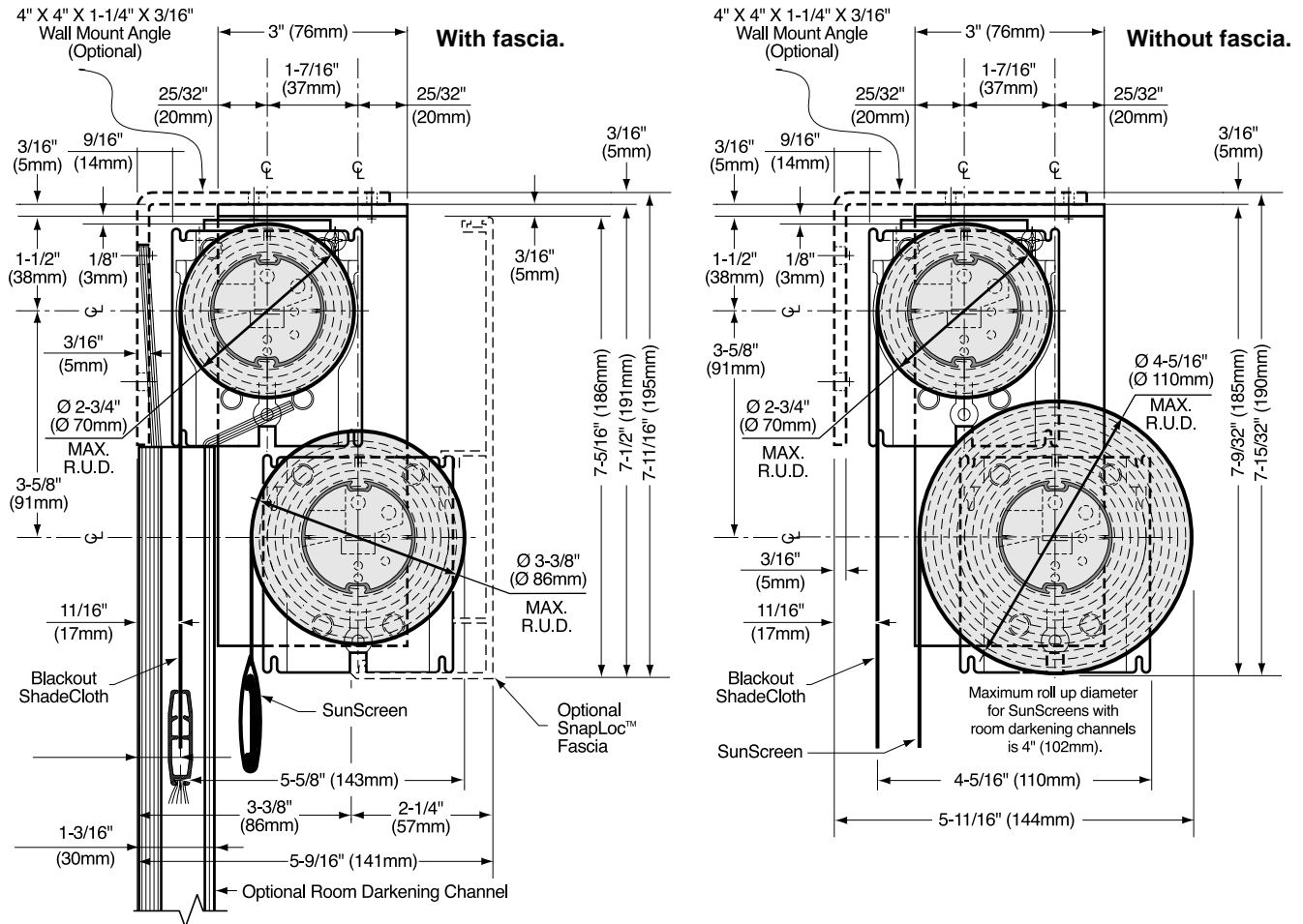

### Maximum Shade Height Guide for DoubleShades

(Confirm with Weights and Measures Book)

The same batten related issues about 1:4 ratio shades and railroaded shades over 84\"/> <th>No Battens</th> <th>One (1) Batten</th> <th>Two (2) Battens</th>	No Battens	One (1) Batten	Two (2) Battens
	1-3/4\"/> <th>1-3/4\"/&gt; <th>1-3/4\"/&gt; </th></th>	1-3/4\"/> <th>1-3/4\"/&gt; </th>	1-3/4\"/>
<b>DoubleShade #20**</b>			
Blackout Rear tube Without fascia	227\"/>		
ThermoVeil® Front tube With or without fascia	109\"/>		
EuroVeil® Front tube With or without fascia	132\"/>		
<b>DoubleShade #21***</b>			
Blackout Top tube Without fascia	227\"/>		
ThermoVeil Bottom tube With fascia	209\"/>		
Without fascia	240\"/>		
EuroVeil Bottom tube With fascia	240\"/>		
Without fascia	240\"/>		

\* Actual maximum heights may be greater, but not recommended, and may exceed the number of motor revolutions.

\*\* DoubleShade #20: No end caps available. \*\*\* DoubleShade #21: No channels available.

MechoShade Systems, Inc.  
 42-03 35th Street, Long Island City, NY 11101  
 Telephone: 718-729-2020  
 Fax: 718-729-2941 / 800-899-8081

E-mail: [info@mechoshade.com](mailto:info@mechoshade.com)  
 Internet Web Site: <http://www.mechoshade.com>

**3.16**  
MS2200 - 6/1/04



# ElectroShade® DoubleShade® Brackets

ThermoVeil® or EuroVeil® SunScreens with Blackout ShadeCloth on a Single Bracket with SnapLoc® Fascia (optional).

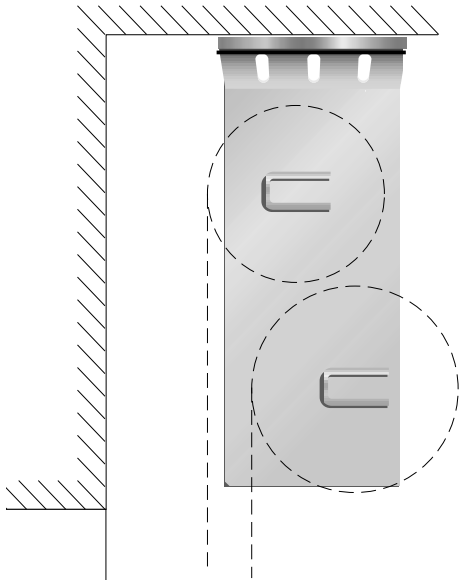

## DoubleShade #13

Shown are the Drive-End brackets. Idle-End and Center Support brackets not shown.

Edge clearances increase by 3/16" (5mm) for DoubleShades #13

DoubleShades® have all the same features of the standard Mecho®/5 bracket, plus allow both sun screen and room darkening on a single bracket.

### Compact Size

DoubleShade's compact size allows two shades to fit in a smaller room projection than two individually installed shades on the same window.

### Ease of Installation

DoubleShades provide faster, easier, more economical installation of two shades per window. The mounting brackets require less measuring and are pre-spaced to insure proper alignment of both shades in relation to each other.

## Electro®/1 DoubleShade® Bracket #13, no fascia available.

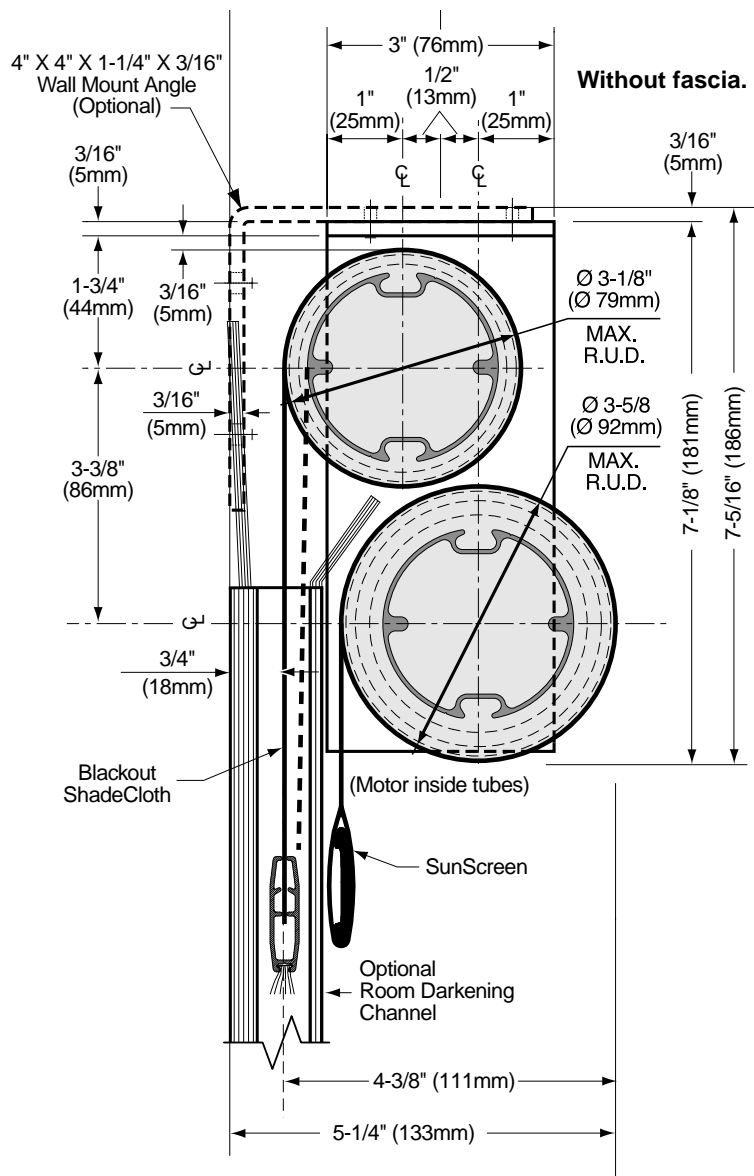

- DoubleShade Brackets require that both the solar and blackout operating brackets on a DoubleShade assembly have the same right-hand drive or left-hand drive orientation.
- For assistance on proper bracket and tube selection please contact your local representative or MechoShade technical support.

MechoShade Systems, Inc.  
42-03 35th Street, Long Island City, NY 11101  
Telephone: 718-729-2020  
Fax: 718-729-2941 / 800-899-8081

E-mail: [info@mechoshade.com](mailto:info@mechoshade.com)  
Internet Web Site: <http://www.mechoshade.com>

3.17  
MS2200-6/1/04



# ElectroShade® DoubleShade® Brackets

## Electro®/2 DoubleShade® Bracket #17, with fascia.

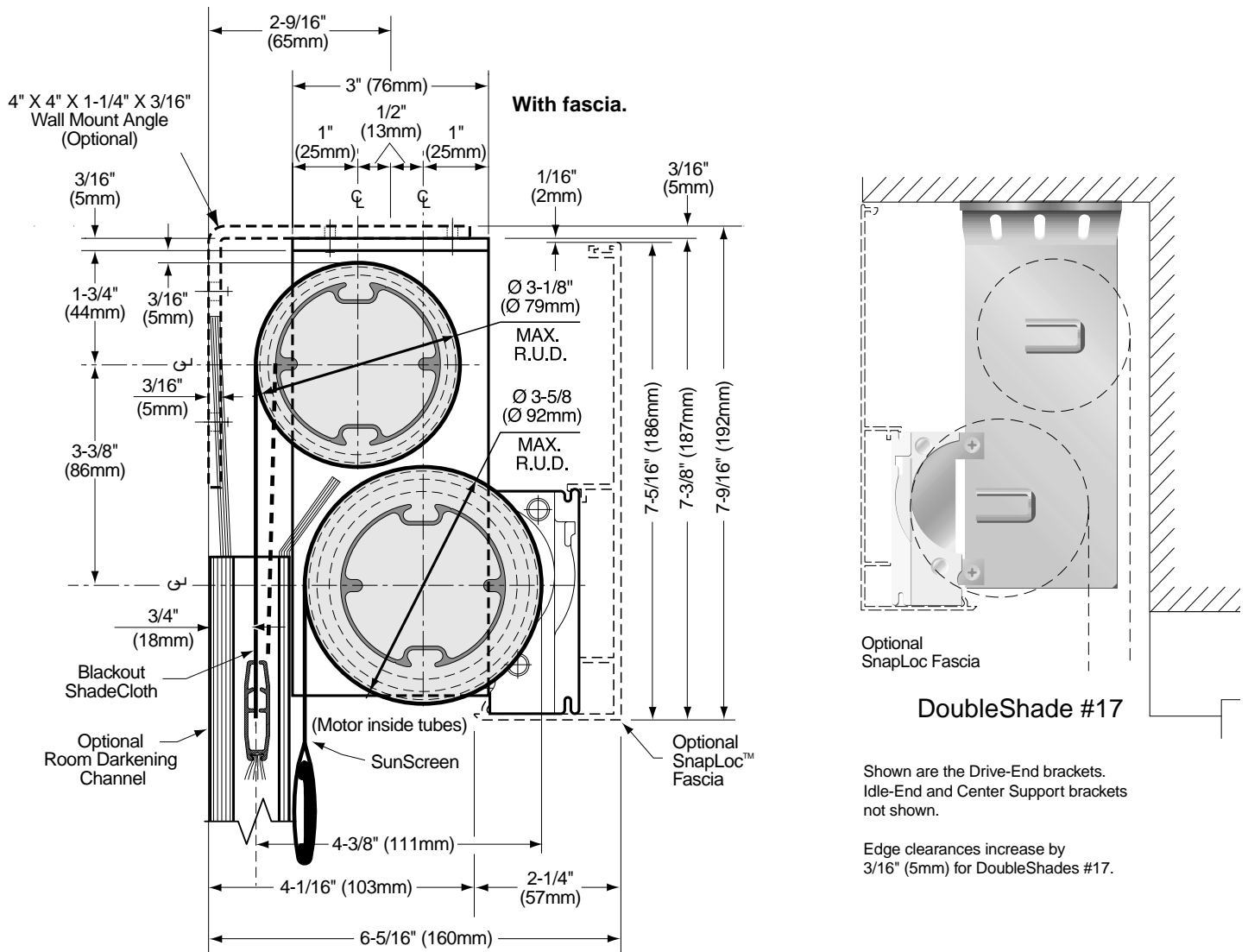

### Maximum Shade Height Guide for DoubleShades

(Confirm with Weights and Measures Book)

The same batten related issues about 1:4 ratio shades and railroaded shades over 84" apply to DoubleShades.			No Battens	One (1) Batten	Two (2) Battens
			2-1/2" (63mm) SnapLoc® Tube	2-1/2" (63mm) SnapLoc® Tube	2-1/2" (63mm) SnapLoc® Tube
<b>DoubleShade™ #13 and #17</b>					
Top Tube	Without fascia	Blackout	166" (422cm)	122" (310cm)	77" (196cm)
Bottom Tube, #17 With fascia		ThermoVeil®	166" (422cm)	140" (355cm)	115" (292cm)
		EuroVeil®	201" (510cm)	171" (434cm)	140" (355cm)
	#13 No fascia	ThermoVeil	166" (422cm)	140" (355cm)	115" (292cm)
		EuroVeil	201" (510cm)	171" (434cm)	140" (355cm)

\* No channels available.

MechoShade Systems, Inc.  
42-03 35th Street, Long Island City, NY 11101  
Telephone: 718-729-2020

E-mail: [info@mechoshade.com](mailto:info@mechoshade.com)  
Internet Web Site: <http://www.mechoshade.com>

3.18  
MS2200-6/104



# ElectroShade® <16° Radius Center Support

With or without SnapLoc® Fascia (Optional).

(Up to 16° = 8° + 8°)

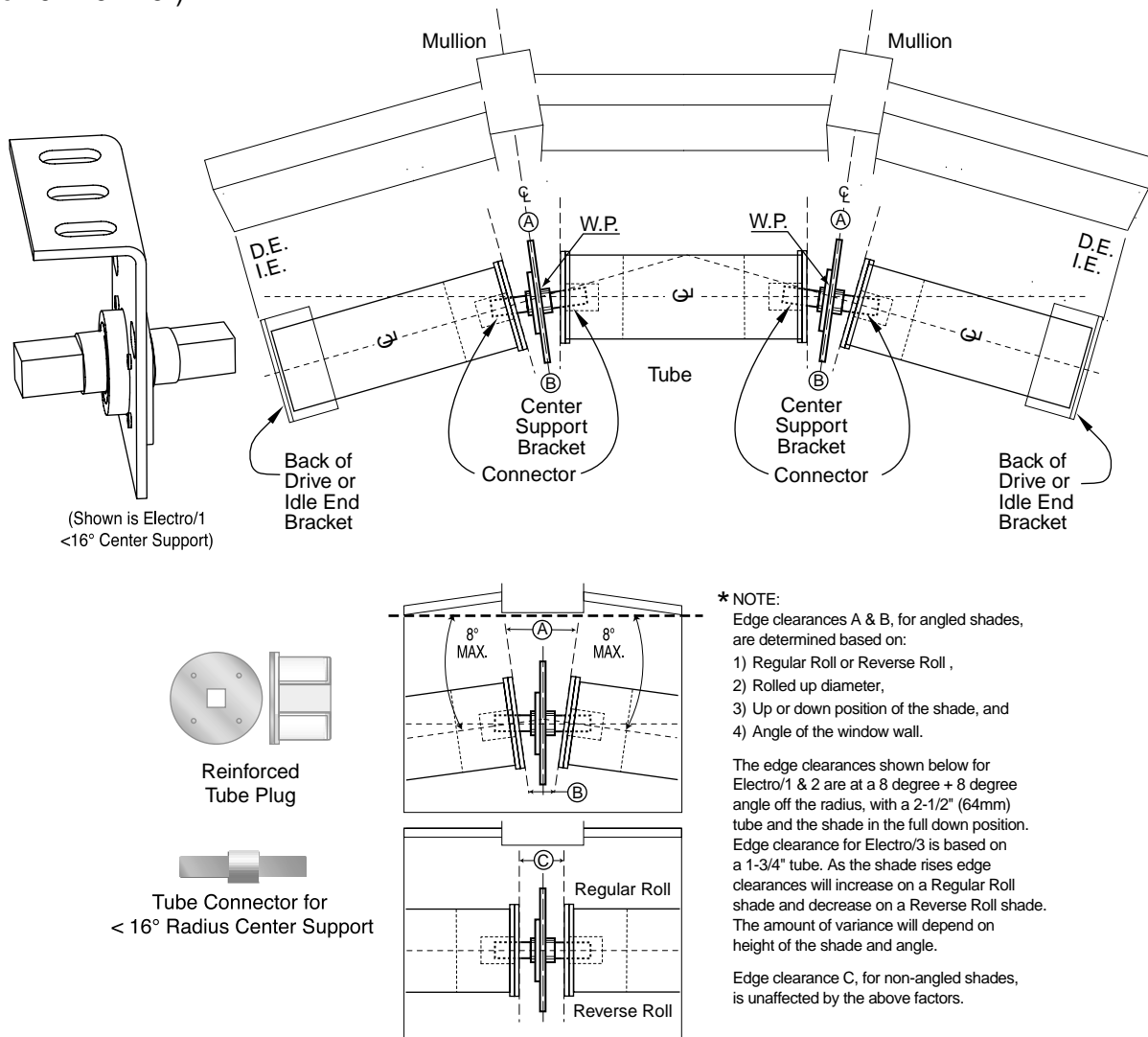

The following < 16° Radius Center Support brackets use the < 16° Radius Tube Connector & a set of reinforced tube plugs.

< 16° Center Support Bracket model	Center Support Edge Clearances*			Maximum Roll Up Diameter
	(A)	(B)	(C)	
Electro®/1	1-9/16" (39mm)	1-7/8" (48mm)	1-1/4" (32mm)	4-1/4" (108mm) No fascia available.
Electro®/1 Extended	1-9/16" (39mm)	1-7/8" (48mm)	1-1/4" (32mm)	6-3/8" (162mm) No fascia available.
Electro®/2	1-9/16" (39mm)	1-7/8" (48mm)	1-1/4" (32mm)	4-1/4" (108mm) with Fascia.
Electro®/2 Extended	1-9/16" (39mm)	1-7/8" (48mm)	1-1/4" (32mm)	6-3/8" (162mm) with Fascia.
Electro®/3	1-1/2" (38mm)	1-7/8" (48mm)	1-1/4" (32mm)	2-3/4" (70mm) with or without Fascia.
Electro®/3 Extended	1-1/2" (38mm)	1-7/8" (48mm)	1-1/4" (32mm)	3-7/16" (87mm) with Fascia.
	1-1/2" (38mm)	1-7/8" (48mm)	1-1/4" (32mm)	5" (127mm) without Fascia

Not available for DoubleShade brackets.  
Call for shop drawings.

MechoShade Systems, Inc.  
42-03 35th Street, Long Island City, NY 11101  
Telephone: 718-729-2020  
Fax: 718-729-2941 / 800-899-8081

E-mail: [info@mechoshade.com](mailto:info@mechoshade.com)  
Internet Web Site: <http://www.mechoshade.com>

**3.19**  
MS2200 - 6/1/04



# ElectroShade® <45° Radius Center Support

With or without SnapLoc® Fascia.

(Up to 45° = 22.5° + 22.5°)

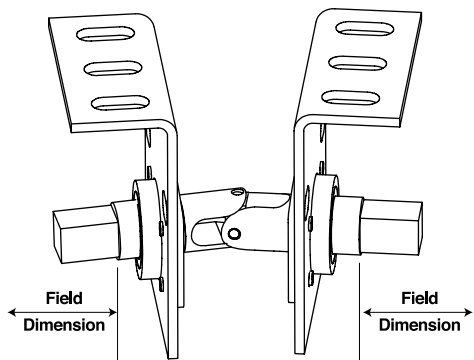
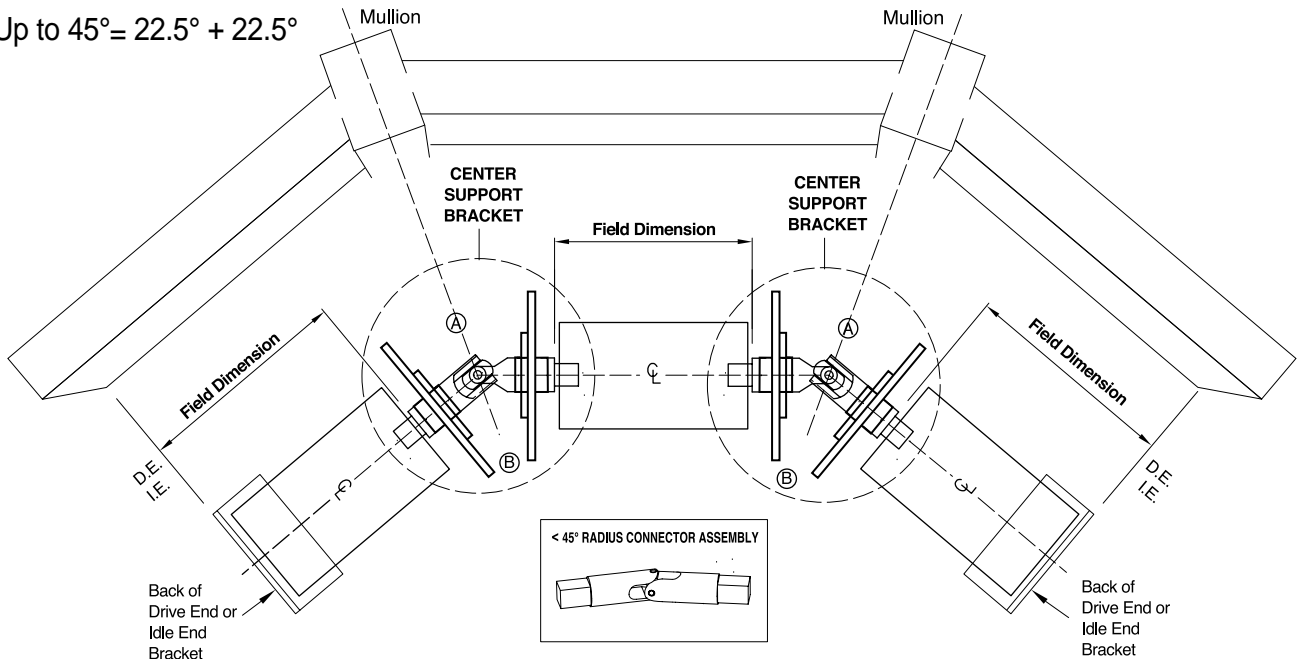

We highly recommend that the brackets be installed before field measurements are taken.

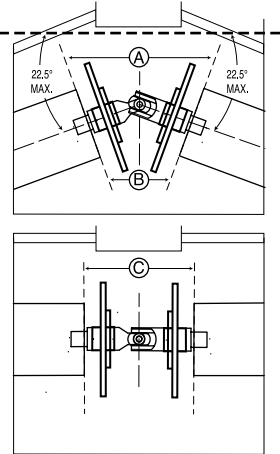

**\* NOTE:**  
 Edge clearances A & B, for angled shades, are determined based on:  
 1) Regular Roll or Reverse Roll,  
 2) Rolled up diameter,  
 3) Up or down position of the shade, and  
 4) Angle of the window wall.

The edge clearances shown below for Electro/1 & 2 are at an 22-1/2 degree + 22-1/2 degree angle off the radius, with a 2-1/2" (64mm) tube and the shade in the full down position. Edge clearance for Electro/3 is based on a 1-3/4" (44mm) tube. As the shade rises edge clearances will increase on a Regular Roll shade and decrease on a Reverse Roll shade. The amount of variance will depend on height of the shade and angle.

Edge clearance C, for non-angled shades, is unaffected by the above factors.

The following < 45° Radius Center Support brackets use the < 45° Radius Universal Joint & a pair of center support brackets.

< 45° Center Support Bracket model	Center Support Edge Clearances*			Maximum Roll Up Diameter
	(A)	(B)	(C)	
Electro®/1	3-13/16" (97mm)	1-15/16" (49mm)	3-1/8" (80mm)	4-1/4" (108mm) No fascia available.
Electro®/1 Extended	3-13/16" (97mm)	1-15/16" (49mm)	3-1/8" (80mm)	6-3/8" (162mm) No fascia available.
Electro®/2	3-13/16" (97mm)	1-15/16" (49mm)	3-1/8" (80mm)	4-1/4" (108mm) with Fascia.
Electro®/2 Extended	3-13/16" (97mm)	1-15/16" (49mm)	3-1/8" (80mm)	6-3/8" (162mm) with Fascia.
Electro®/3	3-9/16" (91mm)	2-5/16" (59mm)	3-1/8" (80mm)	2-3/4" (70mm) with or without Fascia.
Electro®/3 Extended	3-9/16" (91mm)	2-5/16" (59mm)	3-1/8" (80mm)	3-7/16" (87mm) with Fascia.
	3-9/16" (91mm)	2-5/16" (59mm)	3-1/8" (80mm)	5" (127mm) without Fascia

Not available for DoubleShade brackets.  
 Call for shop drawings.

MechoShade Systems, Inc.  
 42-03 35th Street, Long Island City, NY 11101  
 Telephone: 718-729-2020  
 Fax: 718-729-2941 / 800-899-8081

E-mail: [info@mechoshade.com](mailto:info@mechoshade.com)  
 Internet Web Site: <http://www.mechoshade.com>

**3.20**  
 MS2200 - 6/10/4



# Other ElectroShade® Components & Optional Accessories

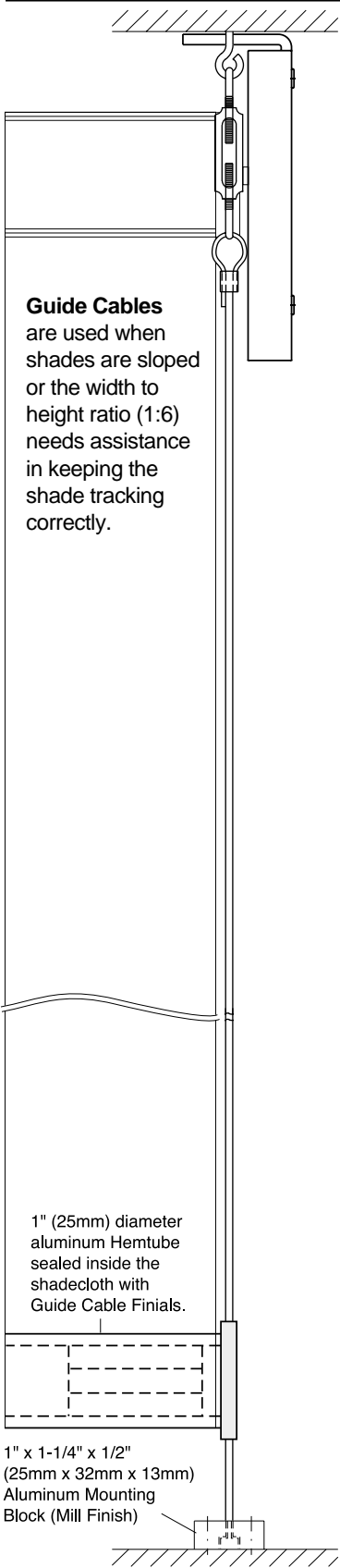

**Guide Cables** are used when shades are sloped or the width to height ratio (1:6) needs assistance in keeping the shade tracking correctly.

1" (25mm) diameter aluminum Hemtube sealed inside the shadecloth with Guide Cable Finials.

1" x 1-1/4" x 1/2"  
(25mm x 32mm x 13mm)  
Aluminum Mounting Block (Mill Finish)

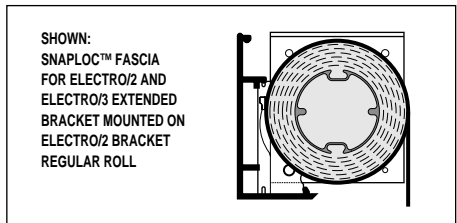

SHOWN:  
SNAPLOC™ FASCIA  
FOR ELECTRO/2 AND  
ELECTRO/3 EXTENDED  
BRACKET MOUNTED ON  
ELECTRO/2 BRACKET  
REGULAR ROLL

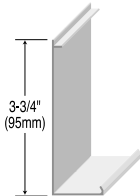

FASCIA FOR  
ELECTRO/3 &  
ELECTRO/3  
DOUBLESHADE #20  
BRACKETS  
REGULAR ROLL  
MFAA RG15 AL \_\_

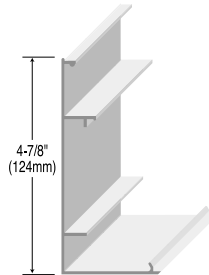

FASCIA FOR  
ELECTRO/2 &  
ELECTRO/3 EXTENDED  
BRACKETS  
REGULAR ROLL  
UFAA 4715 AL \_\_

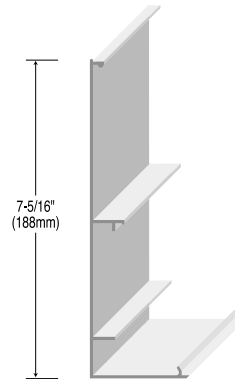

FASCIA FOR  
ELECTRO/2 EXTENDED,  
ELECTRO/2 DOUBLESHADE #17  
& ELECTRO/3 DOUBLESHADE #21  
BRACKETS  
REGULAR ROLL  
UFAA 7321 AL \_\_

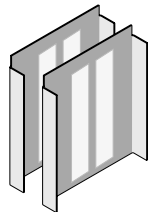

ELECTRO/3  
FASCIA END CAPS (PAIRS)  
MFCA 3036 AL \_\_

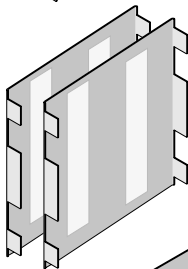

ELECTRO/2 &  
ELECTRO/3 EXTENDED  
FASCIA END CAPS (PAIRS)  
MFCA 3346 AL \_\_

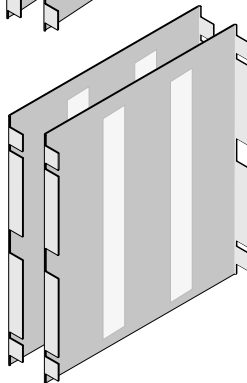

ELECTRO/2 EXTENDED,  
ELECTRO/2 DOUBLESHADE #17  
& ELECTRO/3 DOUBLESHADE #21  
FASCIA END CAPS (PAIRS)  
MFCA 3070 AL

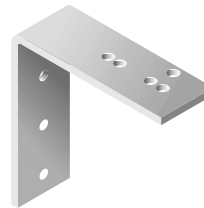

SINGLE WALL-MOUNT ANGLE  
FOR ELECTRO/1, ELECTRO/2  
& ELECTRO/3  
4" x 4" x 1-1/4"  
(102 x 102 x 32 mm)  
EWBX 4040 ST ZP  
Plated

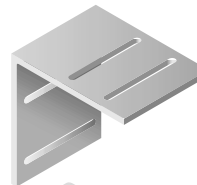

DOUBLE WALL-MOUNT ANGLE  
FOR ELECTRO/1, ELECTRO/2  
& ELECTRO/3  
4" x 4" x 3"  
(102 x 102 x 76 mm)  
EWBX 4145 ST ZP  
Plated

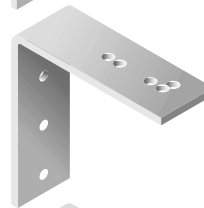

SINGLE WALL-MOUNT ANGLE  
FOR ELECTRO/3,  
ELECTRO/3 POCKET  
& ELECTRO/3 EXTENDED  
4" x 4" x 1-1/4"  
(102 x 102 x 32 mm)  
EWBX 4040 ST ZP  
Plated

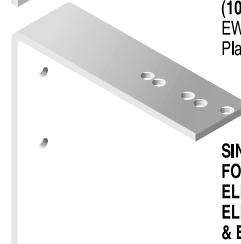

SINGLE WALL-MOUNT ANGLE  
FOR ELECTRO/1 EXTENDED,  
ELECTRO/2 EXTENDED,  
ELECTRO/1 DOUBLE SHADE #13 &  
ELECTRO/2 DOUBLE SHADE #17  
5" x 5" x 1-1/4"  
(127 x 127 x 32 mm)  
UWBX 5050 ST PL

MechoShade Systems, Inc.  
42-03 35th Street, Long Island City, NY 11101  
Telephone: 718-729-2020  
Fax: 718-729-2941 / 800-899-8081

E-mail: [info@mechoshade.com](mailto:info@mechoshade.com)  
Internet Web Site: <http://www.mechoshade.com>

**3.21**  
MS2200 - 6/1/04



# Batten and Seam Specifications

**Battens vs. Seams:** MechoShade Systems, Inc. is one of the only, if not the only, shade manufacturer to use a batten joint vs. a seam joint. This type of construction costs more, but is highly effective in ensuring that certain types of shade bands hang and track straight. See page 2.24 for an illustration of the Batten vs. Seam joint.

**Woven ScreenCloth:** All woven ScreenCloth, regardless if their core yarns are polyester or fiberglass, will stretch under their hanging weight due to "Woven Fabric Mechanical Extensibility" or "The Hour Glass Effect". In order to assure the proper tracking and rolling of the shadeband, and avoid the "Hour Glass Effect", battens are included by MechoShade as a standard detail when the width-to-height (W:H) ratio exceeds 1:4. Railroaded, multi-width shade bands will receive a 1-1/2" (38mm) batten joint. Battens may be specified for shade bands that otherwise do not need them to align with shade bands that do require battens, at additional cost. Battens will be positioned on the shade band, per the chart below, or at customer specified positions, subject to approval of MechoShade Systems, Inc., and may be at additional cost.

## Standard Batten Placement for Non-Railroaded (Standard) ElectroShades:

- Batten placement for non-railroaded shades shall be the minimum required to meet the 1:4 ratio of width to height.
- Battens shall be equally spaced within the shadeband opening height. For example one batten at the mid point, or two battens at 1/3 points, or three battens at 1/4 points.
- Batten placement for blackout shades with side channels shall not exceed 4'-0" (122cm) o.c. and must be specified.

Standard Batten Placement for Railroaded (RR) ElectroShades*				
Roll Widths	63" (160cm) RR*	72" (183cm) RR*	96" (244cm) RR*	126" (366cm) RR*
<b>SHADE HEIGHTS</b>	<b>Requires 1 width Railroaded*, +1 seam</b> 			
	<b>Requires 1-1/2 widths Railroaded*, +1 seam</b> 			
	<b>Requires 2 widths Railroaded*, +1 seam</b> 			
	<b>Requires 2-1/2 widths Railroaded*, +1 seam</b> 			
	<b>Requires 3 widths Railroaded*, +2 seams</b> 			

\* All shades measured from the bottom up to the center line of the batten joint. Railroaded (RR) Shadecloth turned width for height. An additional 9" to 12" (229mm to 305mm) fabric allowance for wrap. Other combinations of widths available (i.e. 1/4, 1/3) subject to MSS acceptance.

## Width-to-Height (W:H) Ratio Guidelines and Edge-Clearance Specifications (fabric used normally or railroaded)

- **Shadebands up to 1:3 W:H ratio**, require the standard edge-clearance deduction except for 30" (76cm) wide shadebands.
- **1:3 to 1:4 W:H ratios**, increase the hardware edge-clearance 1/16" (1.6mm) each side to 1/8" (3.2mm) additional deduction.
- **1:4 to 1:5 W:H ratios**, increase the hardware edge-clearance 1/8" (3.2mm) each side to 1/4" (6.4mm) additional deduction. Battens required.
- **1:5 to 1:6 W:H ratios**, increase the hardware edge-clearance 1/4" (6.4mm) each side to 1/2" (12.8mm) additional deduction. Battens required.
- **Over 1:6 W:H ratios**, increase the hardware edge-clearance 5/16" (8mm) each side to 5/8" (16mm) additional deduction. Battens & guide cables required.
- **Railroaded multi-width shades** with horizontal joints shall have seam joints.
- **Environmental conditions may require** additional use of guide cables and/or battens and increased edge clearance.



MechoShade Systems, Inc.  
 42-03 35th Street, Long Island City, NY 11101  
 Telephone: 718-729-2020  
 Fax: 718-729-2941 / 800-899-8081

E-mail: [info@mechoshade.com](mailto:info@mechoshade.com)  
 Internet Web Site: [www.mechoshade.com](http://www.mechoshade.com)

**3.22**  
 MS2200 - 6/1/04

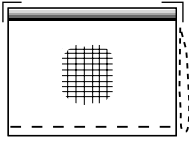
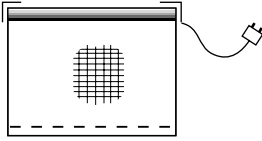
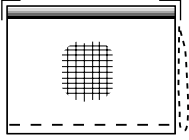

# ShadeWords

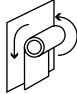
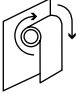
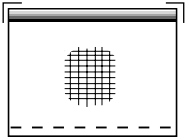
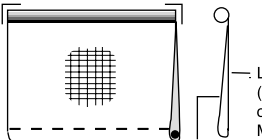
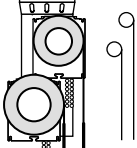
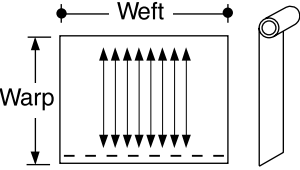
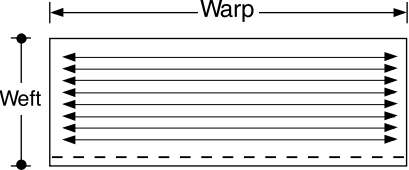
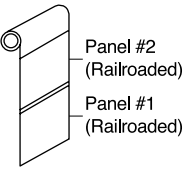
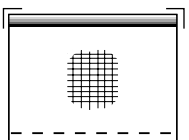
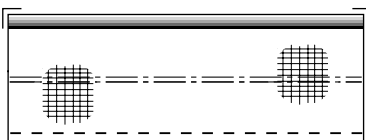
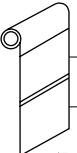
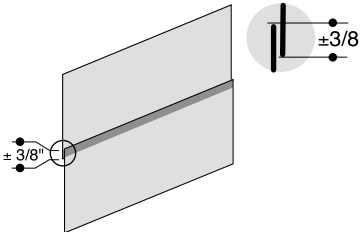
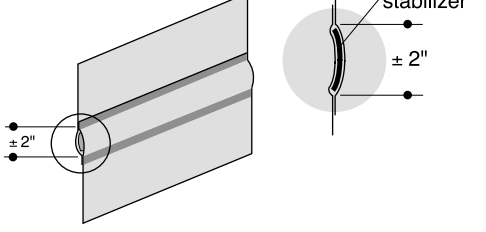
Item	Definition
MechoShade® ElectroShade®	  <p>MechoShade®      ElectroShade®</p>
SingleBand™ MultiBand™ Regular- & Reverse-Roll	    <p>SingleBand      MultiBand™ (2 or more shadebands on one operator MechoShades or ElectroShades)</p> <p>Regular Roll (unwinds towards glass)</p> <p>Reverse Roll (unwinds away from glass)</p>
SingleShade™ DualShade® DoubleShade™	   <p>SingleShade™ (Standard)      DualShade®      DoubleShade™ (2 on1 bracket)</p>
Non-Railroded ShadeCloth (NRR) (Standard) Railroded ShadeCloth (RR) (Landscape)	   <p>Non-Railroded ShadeCloth (ShadeCloth used normally)      Railroded ShadeCloth (ShadeCloth used width for height)</p>
SingleWidth™ MultiWidth™	   <p>SingleWidth™ (No seams)      MultiWidth™ (A shadeband with 2 or more widths joined with a joint batten)</p> <p>(Railroded or Non-Railroded)</p>
Seam joint (Special) Batten joint (Standard)	 

MechoShade Systems, Inc.  
42-03 35th Street, Long Island City, NY 11101  
Telephone: 718-729-2020  
Fax: 718-729-2941 / 800-899-8081

E-mail: [info@mechoshade.com](mailto:info@mechoshade.com)  
Internet Web Site: <http://www.mechoshade.com>

3.23  
MS2200 - 6/1/04



# Electro<sup>®</sup>/1, 2 & 3 Hardware Features and Specifications

The ElectroShade<sup>®</sup> system is designed, developed and fabricated to be a totally integrated unit and is furnished by the manufacturer, MechoShade Systems, Inc., with a warranty which provides that all components (motor, shade cloth, electrical controls and override circuits) have been designed and tested as a compatible integrated system.

The basic control configuration is one or two ElectroShades controlled from a single line voltage D.P.D.T. switch. For control of three or more motors from a single switch, or for mid window shade alignment at the touch of a button, a multi-motor controller such as the MLC<sup>™</sup>, I•CON, IQ/MLC<sup>™</sup> or IMCS<sup>™</sup>/2 is required. (See Controls Section.)

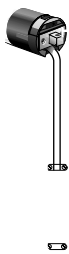

## 1.0 ElectroShade Hardware

**1.1 Mounting Brackets:** The drive assembly, idle-end assembly, and center support systems are attached to a 1/8 in. (3mm) steel mounting bracket.

**1.2 Shade Roller:** Extruded aluminum tube, 6063-T6 alloy, 1-3/4 in. (44 mm), 2-1/2 in. (63 mm), 3-1/2 in. (90 mm) or 4-1/2 in. (114 mm) OD (as required) with internal keyway to receive tubular motor. The tube is extruded with two fabric-mounting channels designed to support the shade bands via the SnapLoc<sup>®</sup> spline (see below).

**1.3 SnapLoc<sup>®</sup> Mounting Spline:** Extruded vinyl with asymmetrical locking channels and embossed fabric guide for use with 1-3/4 in. (44 mm), 2-1/2 in. (63 mm), 3-1/2 in. (90 mm) or 4-1/2 in. (114 mm) OD tube. Spline has sufficient capacity to support the shade and additional hem weights without disengaging from the tube or without extra wraps of fabric on the tube. SnapLoc Spline shade band assembly may be installed or removed from the shade tube, or tube/motor assembly, without disassembling or removal from the mounting brackets.

**1.4 End Brackets:** Consist of 1/8 in. (3 mm) thick sheet steel. Wall, jamb or ceiling mounted as required and permanently installed.

**1.5 Center Support Brackets:** Supplied to allow multibanding. Ceiling or wall mounted. Center support brackets shall accept continuous lengths of fascia, which will span two or more ElectroShade bands up to maximum length of 15 feet (457cm) per section.

**1.6 Hembar Weights:** Mill-finished aluminum bars in single lengths as appropriate for the size shade, concealed in a fabric hem pocket.

**1.7 Exposed hembars** in painted and baked PPG finishes with key way for shades.

**1.8 DualShade<sup>®</sup> System:** The patented DualShade system, by MechoShade Systems, Inc., for installing both a ThermoVeil<sup>®</sup> sun screen together with either a room darkening shade cloth or MirroFilm<sup>™</sup> attached to the same roller tube by means of the SnapLoc spline. The shade cloth and film shall be separated by 1/2 in. (13 mm) of insulating air space.

**1.9 Optional SnapLoc<sup>®</sup> Fascia:** SnapLoc<sup>®</sup> fascia shall be provided for standard and extended height brackets and center support brackets. Each bracket assembly permits the fascia to extend past the brackets, creating wall-to-wall fascia, with the brackets mounted inboard from the end of the fascia. SnapLoc fascia can be installed as a single unit over two or more shade band assemblies without exposed joints in lengths up to 15 ft. (457cm). SnapLoc fascia snaps on to the brackets without the use of glue, magnetic strips or any exposed fastening.

The fascia is made of extruded aluminum (hardness/alloy 6063T5) with an average thickness of .062 in. (1.6mm).

The fascia is finished in PPG Duracon<sup>™</sup> baked enamel in six standard colors plus clear aluminum.

**1.10 DoubleShade<sup>®</sup> Mounting Brackets:** A master mounting bracket assembly for drive-end, idle-end and center supports to facilitate installation of two shades, front-to-back or top and bottom, with precise alignment and minimum installation labor. DoubleShade<sup>®</sup> brackets have all the same features of the standard ElectroShade bracket, plus allow both sun screen and blackout shades on a single bracket. DoubleShade's compact size allows two shades to fit in a smaller room projection than two individually installed shades on the same window.



# Electro<sup>®</sup>/1, 2 & 3 Hardware Features and Specifications

---

## 2.0 ElectroShade<sup>®</sup> Motor System

**2.1 Limit Switches:** Internal limit switches are adjusted by two external push button, thumb screws or electronically set to allow exact setting of travel in both the raised and lowered positions. Micro switches provide circuit braking at the end of the run. The limit switch setting cannot be disturbed by the action of the roller tube.

**2.1.1 Intelligent Motors with Busline Control** may have either manual, push-button or electronic limit switch adjustment.

**2.2 Brake:** A solenoid activated disc brake mechanism stops and holds in any position. The brake automatically disengages when the motor is operating.

**2.3 Motor:** An asynchronous (non-synchronous) motor with built-in reversible capacitor start-and-run is made to be operated with 95 to 125 VAC at 60hz. (207-253), single phase, temperature Class-A (maximum temperature rating of 140 C.), thermally protected, totally enclosed, maintenance free with locking disconnect plug assembly furnished with each operator.

**2.4 Gear Box:** Three or more levels of satellite gears are provided for load distribution (planetary gears) and machined from close tolerance tempered steel or molded plastic. The speed varies according to model from 10 r.p.m. to 64 r.p.m.

**2.5 Installation:** A single pin locks the drive end of the motor to the tube. A notched section of the tube turns the ring, which counts the turns and activates the limit switch. To interchange motors, the pin is pressed out of the tube and the motor slides out.

**2.6 Sizes:** The motors are available in torques of 35-435 in. lbs. (lifting capacity), 10-64 r.p.m. speed to meet specified requirements and shall not exceed 60 mm in diameter as 115 VAC (230VAC) motors.

**2.7 Connectivity:** Motors are available with either a one foot motor lead with a male Disconnect Plug (power plug). The Disconnect Plug end can be plugged into a compatible Plug-In Receptacle or a Junction Box lead with a female Disconnect Plug.

**2.8 Warranty:** The manufacturer provides warranty that the motor is free of manufacturing defects for five (5) years from the date of installation. This warranty is void if the products have been improperly installed, wired or subjected to improper care. Warranty void if controlled by control systems not previously approved by MechoShade Systems, Inc.

## 3.0 Shade Cloth, Films and Laminates

(See Section 5 for specifications of ThermoVeil<sup>®</sup>, EuroVeil<sup>®</sup> and DualShades<sup>®</sup>.)



# MechoShade® Limited Warranty (Non-Depreciating)



## LIMITED WARRANTY (interior product use)

MechoShade Systems, Inc. warrants to original purchasers that its Interior Use Products are free of manufacturing defects in factory materials or workmanship for the specified warranty period.\*

- ThermoVeil®, EuroVeil®, Faux Natural™, EuroTwill™, Equinox™ and Soleil® brand **shadecloths** on the associated MechoShade®, ElectroShade®, or Suburban™/2 brand shade systems are warranted to be free of manufacturing defects in factory materials or workmanship for the specified warranty period.
- MechoShade®, ElectroShade®, SlimLine™, and Suburban™/2 brand **hardware** are warranted to be free of manufacturing defects in factory materials or workmanship for the specified warranty period.
- ElectroShade®, Motors and Controls are warranted to be free of manufacturing defects in factory materials or workmanship for 5 years from date of shipment.
- Hardware and shadecloths have a Lifetime Warranty not to exceed 25 year from the date of shipment.
- All Limited Warrantees are subject to the general terms and conditions of sale. Copies are available upon request.

## MechoShade®/5 System\*

Lifetime Limited Warranty to original purchasers on all hardware and shade cloths for the life of the interior project for which it was originally purchased, not to exceed twenty-five years.



## MechoShade® SlimLine™ System\*

10-Year Limited Warranty to original purchasers on all hardware and shade cloths.



## ElectroShade® System\*

Lifetime Limited Warranty to original purchasers on all hardware and shade cloths for the life of the interior project for which it was originally purchased, not to exceed twenty-five years.



5-Year Limited Warranty on Motors and Electronics to be free of manufacturing defects in factory materials or workmanship for 5 years from date of shipment.

## Suburban™/2 System\*

10-Year Limited Warranty to original purchasers on all hardware and shade cloths. A 5-Year Limited Warranty for motors and electronic controls.



All in accordance with MechoShade Systems, Inc. Warranty General Terms and Conditions. The MechoShade Limited Warranties are exclusive and in lieu of all other warranties, whether written, oral or implied (including any implied warranty of merchantability, fitness for a particular purpose, or otherwise).

Continued

MechoShade Systems, Inc.  
42-03 35th Street, Long Island City, NY 11101  
Telephone: 718-729-2020  
Fax: 718-729-2941 / 800-899-8081

E-mail: [info@mechoshade.com](mailto:info@mechoshade.com)  
Internet Web Site: [www.mechoshade.com](http://www.mechoshade.com)

3.26  
MS2200 - 6/1/04



# MechoShade® Warranty General Terms and Conditions

## From the Warranty portion of the MechoShade Systems, Inc. General Terms and Conditions of Sale

(INTERIOR USE PRODUCTS)

### VII. WARRANTY

MechoShade Systems, Inc. MSS warrants to the original purchaser that its products are free of manufacturing defects in factory materials or workmanship for the following specified warranty periods:

Hardware and ShadeCloth (Interior use):

- Lifetime of the interior project for which it was originally purchased, from date of shipment for the Mecho®/5 and ElectroShade Systems, but not to exceed 25 years.
- 10 years from date of shipment for the Mecho SlimLine System.
- 10 years from date of shipment for the Suburban™/2 System.

Controls, Electrical, Electronic Accessories and Motors (interior use):

- 5 years from date of shipment for ElectroShade and Suburban/2 products.

Monumental Shades:

MechoShade Warrantee for Monumental Shades shall be limited to 10 years for hardware and shade cloth; 5 years for motors and electronics. Monumental Shades are defined to be any shade band over 300 Sq. ft. and shall be wider than 20 ft. and/or higher than 30 ft.

If any part of a MSS product (except for images or artwork on shade cloths) is found in the reasonable judgment of MSS to be defective in factory materials or workmanship during the above-prescribed warranty periods, MSS will repair or replace the defective part at its option. Repair or replacement under this warranty does not include labor or costs for installation, reinstallation, or removal of MechoShade products, parts or components. This warranty extends only to the original purchaser for MSS products installed by an authorized MechoShade dealer representative with a valid written dealer representative agreement with MechoShade® Systems, Inc. The MechoShade®/5 System and ElectroShade® System Lifetime Limited Warranty is void unless the warranty card is filled out and returned to MSS within 120 days of shipment.

This warranty does not apply if any of the following exclusions exist:

- The product has been subject to misuse, abuse, neglect, negligence, accident, or has been operated in any way contrary to MSS's operating instructions or specifications.
- Damages or conditions that have resulted from improper cleaning, maintenance, care or repair of the product.
- The product has been improperly installed or not installed according to MSS's guidelines or specifications.
- MSS's written instructions for installation and wiring of electrical connections were not followed.
- The product has been used to perform functions or operated in a manner contrary to its design or otherwise is used in a manner contrary to or in excess of MSS's specifications, drawings, or instructions.
- The product is used with electrical accessories or parts, including switches, relays, or other accessory components, that have not been previously approved in writing by the MSS Engineering Department.
- If any electrical accessories and other components have been used in disregard to the basic wiring diagram for which they were designed.
- Failure to comply with all MSS's written instructions and specifications.
- Repairs made necessary from normal wear of the product or by use of parts or accessories which are either incompatible with the product or otherwise adversely affect its operation, performance, or durability.
- Product used for non interior applications or otherwise exposed to outdoor environmental conditions.

MSS reserves the right to change or improve the design of any MechoShade product without assuming any obligation to modify or retrofit any product previously manufactured or supplied.

MSS does not warrant any images or artwork reproduced, printed, or placed on shade cloth by MSS or any imaging supplier, and MSS is not otherwise responsible or liable for fading, discoloration, color shifts, or any other failure or defect in such images or artwork.

MSS requires that the Buyer license or own the right to reproduce all images or artwork, photographs and other intellectual property provided by the Buyer, its agents, or customers. The Buyer shall indemnify, defend, and hold harmless MSS, its imaging supplier, and their employees and officers against any claims or actions for alleged or actual copyright or trademark infringement or any other claims resulting from reproduction of the images or artwork in any form or any other use of the images or artwork by buyer, MSS, its imaging supplier, or other third parties.

**THE FOREGOING WARRANTIES ARE EXCLUSIVE AND IN LIEU OF ALL OTHER WARRANTIES, WHETHER WRITTEN, ORAL OR IMPLIED (INCLUDING ANY IMPLIED WARRANTY OF MERCHANTABILITY, FITNESS FOR A PARTICULAR PURPOSE, OR OTHERWISE). MSS SPECIFICALLY DISCLAIMS ALL OTHER EXPRESS OR IMPLIED WARRANTIES, INCLUDING MERCHANTABILITY, FITNESS FOR A PARTICULAR PURPOSE, OR OTHERWISE IN THEIR ENTIRETY. MSS' OBLIGATION UNDER THIS WARRANTY IS STRICTLY AND EXCLUSIVELY LIMITED TO THE REPAIR OR REPLACEMENT OF DEFECTIVE PARTS AS HEREIN DESCRIBED, AND MSS DOES NOT ASSUME OR AUTHORIZE ANYONE TO ASSUME FOR MSS ANY OTHER OBLIGATION, WHETHER WRITTEN, ORAL OR IMPLIED. NOTWITHSTANDING ANY OTHER REPRESENTATIONS OR AGREEMENTS BY ANY PARTY OR NON PARTY, WHETHER WRITTEN, ORAL OR IMPLIED.**

**MSS ASSUMES NO RESPONSIBILITY AND SHALL NOT BE LIABLE TO THE ORIGINAL PURCHASER OR ANY OTHER PARTY OR NON PARTY FOR ANY PERSONAL INJURY, LOSS, OR DAMAGE, WHETHER DIRECT, LIQUIDATED, INCIDENTAL, OR CONSEQUENTIAL, INCLUDING BUT NOT LIMITED TO THE LABOR OR COSTS RELATED TO THE REPLACEMENT OF A DEFECTIVE PRODUCT OR PARTS OR INSTALLATION, REINSTALLATION, OR REMOVAL OF SUCH PRODUCT OR PARTS, EXPENSE OF RETURNING A PRODUCT OR PART TO MSS OR ITS AUTHORIZED DEALER OR THE EXPENSE OF DELIVERING IT BACK TO THE ORIGINAL PURCHASER, LOSS OR DAMAGE TO PERSONAL OR REAL PROPERTY, LOSS OF REVENUE, LOSS OF THE USE OF THE PRODUCT, LOSS OF TIME, OR INCONVENIENCE.**

This warranty gives the original purchaser specific legal rights, and the original purchaser may also have other rights which vary from state to state.

**For a copy of our General Terms and Conditions of Sale, please see the last section of this binder or contact MechoShade Systems, Inc.**

MechoShade Systems, Inc.  
42-03 35th Street, Long Island City, NY 11101  
Telephone: 718-729-2020  
Fax: 718-729-2941 / 800-899-8081

E-mail: [info@mechoshade.com](mailto:info@mechoshade.com)  
Internet Web Site: [www.mechoshade.com](http://www.mechoshade.com)

**3.27**  
MS2200 - 6/1/04



